

RESOLUTION NO. 828

**RESOLUTION IN LIEU OF BOND
PERFORMANCE GUARANTEE FOR THE CONSTRUCTION OF THE
KENTUCKY CROSSING STORMWATER POND RELOCATION PROJECT
PHASES 2 & 3 UNDER COUNTY PERMIT PA-2024-01**

WHEREAS, Douglas County, as a condition of service, requires that East Wenatchee Water District (District) provide indemnification in the form of a bond or other acceptable guarantee for the construction and relocation of the existing storm water facilities associated with Kentucky Crossing Phases 2 & 3, and

WHEREAS, The East Wenatchee Water District guarantees the construction of this facility to meet the current construction standards of Douglas County and the Washington State Department of Ecology's Storm Water Manual for Eastern Washington, and

WHEREAS, The East Wenatchee Water District will construct the facility within an eighteen (18) month period, from the date of plat approval for permit PA-2024-01, and

WHEREAS, once this facility and associated roadway improvements have been completed and accepted by Douglas County, the East Wenatchee Water District will provide a 24 month guarantee of the aforementioned improvements. See exhibit "A" for all listed improvements.

WHEREAS, the existing stormwater facility currently serving the Kentucky Crossing Subdivision shall remain functional and will be maintained by East Wenatchee Water District until such time that the new stormwater facility is constructed and accepted by Douglas County.

NOW THEREFORE BE IT HEREBY RESOLVED, that the Board of Commissioners of the East Wenatchee Water District approves this Performance Guarantee for the construction and maintenance period for the project under Douglas County permit PA-2024-01 will be completed as described.

ADOPTED, by the BOARD OF COMMISSIONERS of the EAST WENATCHEE WATER DISTRICT, Douglas County, Washington at a regular meeting thereof, this 15th day of May, 2024.

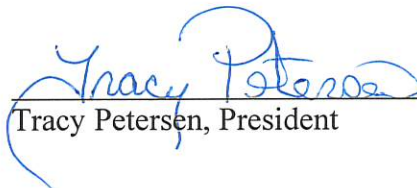

Tracy Petersen, President

ATTEST:



Terry Barnes, Secretary



EAST WENATCHEE WATER DISTRICT Kentucky Crossing Stormwater Pond Relocation

Exhibit A

PROJECT VICINITY MAP

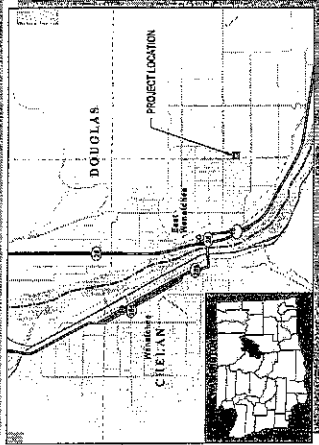

PROJECT LOCATION MAP

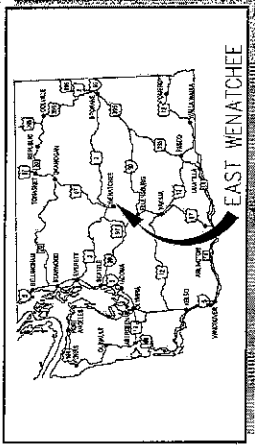

CALL 48 HOURS BEFORE YOU DIG
ONE CALL 811
REPORT ALL SPILLS
DEPT. OF ECOLOGY 1-800-258-5990

GENERAL NOTES

1. ALL WORKMANSHIP, CONSTRUCTION AND MATERIALS SHALL BE PERFORMED OR SUPPLIED IN ACCORDANCE WITH THESE SPECIAL PROVISIONS, PLANS, DOUGLAS COUNTY STANDARD DETAILS, AND THE KENTUCKY STANDARD SPECIFICATIONS FOR CONSTRUCTION AND THE AMERICAN PUBLIC WORKS ASSOCIATION (AWWA) STANDARD SPECIFICATIONS REFERRED TO AS THE STANDARD SPECIFICATIONS.
2. A RECONSTRUCTION CONFERENCE IS REQUIRED PRIOR TO CONSTRUCTION, AND 48 HOURS ADVANCE NOTIFICATION PRIOR TO ACTUAL START OF WORK IS REQUIRED.
3. THE EXISTING TOPOGRAPHIC AND PHYSICAL FEATURES SHOWN ON THESE PLANS ARE BASED ON RECORD DRAWINGS, AND FIELD RECONSTRUCTION BY THE ENGINEER.
4. THE LOCATIONS AND ELEVATIONS OF EXISTING UNDERGROUND UTILITIES SHOWN ON THE PLANS WERE OBTAINED FROM AVAILABLE RECORDS BUT HAVE NOT BEEN EXPLORED AND MEASURED. THE CONTRACTOR SHALL BE RESPONSIBLE FOR THE EXACT LOCATION OF ALL EXISTING UTILITIES PRIOR TO COMMENCING WORK TO AVOID DAMAGE OR DISTURBANCE, AND AGREE TO BE FULLY RESPONSIBLE FOR ANY AND ALL DAMAGES WHICH MIGHT BE CAUSED BY THE CONTRACTOR'S FAILURE TO EXACTLY LOCATE AND RESERVE ALL UNDERGROUND UTILITIES. IT IS UNDERSTOOD THAT OTHER ABOVE GROUND UNDERGROUND UTILITIES NOT SHOWN ON THE PLANS MAY BE ENCOUNTERED DURING THE COURSE OF THE WORK.
5. THE CONTRACTOR SHALL PROTECT BUILDINGS, FENCES, APPURTENANCES, ABOVE GROUND UTILITIES, AND OTHER PROPERTY ADJACENT TO ALL CONSTRUCTION AREAS. THE CONTRACTOR SHALL BE SOLELY RESPONSIBLE FOR REPAIRING ALL DAMAGE CAUSED BY CONSTRUCTION ACTIVITIES.
6. IN ACCORDANCE WITH THE DEPARTMENT OF ECOLOGY AIR QUALITY STANDARDS, THE CONTRACTOR SHALL BE RESPONSIBLE FOR CONTROLLING ALL DUST THAT MAY BE GENERATED BY THE CONSTRUCTION PROJECT.
7. THE CONTRACTOR SHALL CONTAIN WORK TO WITHIN RIGHTS-OF-WAY OR THE CONSTRUCTION LIMITS AS ILLUSTRATED IN THE PLANS.
8. THE CONTRACTOR SHALL SECURE NECESSARY PERMITS PRIOR TO STARTING CONSTRUCTION. THE EAST WENATCHEE DISTRICT HAS THE NECESSARY PERMITS FOR THIS PROJECT. THE CONTRACTOR SHALL OBTAIN ALL NECESSARY INFORMATION REGARDING PERMITS.
9. CRISTE EROSION CONTROL MEASURES SHALL BE THE RESPONSIBILITY OF THE CONTRACTOR AND BE IN PLACE PRIOR TO CONSTRUCTION. ANY PROGRAMS OCCURRING BEFORE FINAL ACCEPTANCE BY THE EAST WENATCHEE WATER DISTRICT, OR AS OTHERWISE CONTROLLED BY THE ENGINEER, THE CONTRACTOR SHALL REMOVAL ALL TEMPORARY, NON-DURABLE EROSION CONTROL MEASURES.
10. ANY REVISIONS TO PLANS MUST BE MADE BY THE ENGINEER AND APPROVED BY THE EAST WENATCHEE WATER DISTRICT PRIOR TO ANY IMPLEMENTATION IN THE FIELD.
11. ALL PAVEMENT MARKINGS AND SIGNS SHALL CONFORM TO THE REQUIREMENTS OF THE WDPOD.
12. A COPY OF THE APPROVED PLANS MUST BE ON THE JOB SITE WHICHEVER CONSTRUCTION IS IN PROGRESS.
13. WHERE NEWLY CONSTRUCTED PAVING MEETS EXISTING PAVING, THE CONTRACTOR SHALL SAW CUT OR OVERLAY AND FEATHER NEW PAVEMENT TO PROVIDE A SMOOTH TRANSITION FROM EXISTING TO PROPOSED PAVING. APPLICATION OF A THIN TACK COAT OF EMULSIFIED ASPHALT SHALL BE APPLIED TO INSURE PROPER BONDING.
14. THE COMPLETED SURFACE OF ALL COURSES SHALL BE OF UNIFORM TEXTURE, SMOOTH UNIFORM AS TO CROWN AND GRADE, AND FREE FROM DEFECTS OF ALL KINDS. THE COMPLETED SURFACE OF THE WEARING COURSE SHALL NOT VARY MORE THAN 1/8 INCH FROM THE LOWER EDGE OF A 18-FOOT STRAIGHTEDGE PLACED ON THE SURFACE PARALLEL TO THE CENTERLINE. THE TRANSVERSE SLOPE OF THE COMPLETED SURFACE OF THE WEARING COURSE SHALL VARY NOT MORE THAN 1/8 INCH IN 10 FEET FROM THE RATE OF TRANSVERSE SLOPE SHOWN ON THE PLANS.
15. MATERIALS SAMPLING AND TESTING SHALL BE AT A FREQUENCY AND MAGNITUDE AS SPECIFIED IN THE STANDARD SPECIFICATIONS OR DETERMINED BY THE ENGINEER. A PRIVATE AND INDEPENDENT TESTING LABORATORY SHALL PERFORM TESTING AND SAMPLING. CERTIFIED TEST REPORTS SHALL BE FURNISHED FOR ALL TESTS PERFORMED BY AN INDEPENDENT TESTING LABORATORY. THE EAST WENATCHEE WATER DISTRICT WILL BE RESPONSIBLE FOR ACCEPTANCE TESTING.

DRAWING INDEX

Sheet Number	Sheet Title	Dwg No
1	GENERAL NOTES	001
2	DEMOITION AND ROADWAY DETAILS	002
3	CIVIL PLAN AND PROFILE	003
4	POUND DETAILS	004
5	TRAFFIC CONTROL - SMALLER CLOSURE - LOW SPEED	005

SUBSURFACE UTILITY LEGEND

THE CLASSIFICATIONS FOR SUBSURFACE UTILITIES ARE OUTLINED AND EXPANDED IN THE FOLLOWING LIST:

UTILITY QUALITY LEVEL A.
 - PRECISE HORIZONTAL AND VERTICAL LOCATION OF UTILITIES PREVIOUSLY EXPOSED AND SURVEYED UTILITIES AND SUBSEQUENT MEASUREMENT OF SUBSURFACE UTILITIES, USUALLY AT A SPECIFIC POINT, UNLESS OTHERWISE NOTED, SHALL BE AS CONDUCTED BY THE ENGINEER. THE UTILITY SHOULD BE ASSUMED TO BE QUALITY LEVEL A.

UTILITY QUALITY LEVEL B.
 - INFORMATION OBTAINED THROUGH THE APPLICATION OF GROUND PENETRATING RADAR (GPR) TO IDENTIFY UTILITIES. THE EXISTENCE AND APPROXIMATE HORIZONTAL POSITION OF SUBSURFACE UTILITIES.

UTILITY QUALITY LEVEL C.
 - INFORMATION OBTAINED BY SURVEYING AND PLOTTING VISIBLE ABOVE-GROUND UTILITY FEATURES.

UTILITY QUALITY LEVEL D.
 - INFORMATION DERIVED FROM EXISTING RECORDS OR ORAL RECOLLECTIONS.

NOTE: THE USE OF THE LINE TYPES PROVIDED ABOVE WAS A PRIMARY METHOD FOR INDICATING THE INFORMATION OF THE UTILITIES SHOWN ON THESE PLANS. WHEN THE SOURCE OF THE UNAVAILABLE QUALITY LEVEL WAS USED AS THE DESIGNATION.

SECTION AND DETAIL REFERENCES

THE FOLLOWING CONVENTIONS HAVE BEEN USED WITHIN THESE DRAWINGS TO REFER THE READER BETWEEN THE SECTION DETAIL AND THE PLAN FROM WHICH IT IS REFERENCED:

PLAN REFERENCE BUBBLE - REFERS READER BACK TO THE PLAN FROM WHICH THE DETAIL SECTION REFERENCE BUBBLE - REFERS READER TO THE DRAWING ON WHICH THE DETAIL SECTION IS LOCATED.

WHERE: X - SECTIONAL REFERENCE BY DRAWING NUMBER ON WHICH DETAIL, ORIGINAL OR REVISION.

SECTIONAL REFERENCE ID CONVENTIONS:
 SECTIONS OR ELEVATIONS SHOULD HAVE A LETTER REFERENCE ID (A-Z) AND DETAILS SHOULD HAVE A NUMERICAL REFERENCE ID (0-99)

ABBREVIATIONS

CS	CATCH BASIN	N	NORTING
CONG	CONCRETE	PE	POLYETHYLENE
CL	CENTERLINE	PROP	PROPOSED
CSHC	CRUSHED SLACKS	PVC	POLYVINYL CHLORIDE
CSRC	CRUSHED SLACKS	FR	FIBER
DMM	DIAMETER	ROW	RIGHT-OF-WAY
D	DUCTILE IRON	SPEC	SPECIFICATIONS
E	EASINGS	SSA	SEWER
ELEV	ELEVATION	ST	STORM
ESP	EDGE OF PAVEMENT	STA	STATION LINE
EX	EXISTING	STD	STANDARD
FW	FRESH WATER	TYP	TYPICAL
LT	LEFT	W	WATER
LF	LINEAR FEET		

CONTACT PERSONNEL

CONTACT	AGENCY	PHONE (502)
RYAN BEHRENS, P.E. (PROJECT MANAGER)	RIE ENGINEERING	894-4770
PULL YOUNG, P.E. (SEWER ENGINEER)	RIE ENGINEERING	894-4770
SONJERMENT (STAFF ENGINEER)	RIE ENGINEERING	894-4770
COLBY THORPE (DISTRICT MANAGER)	EAST WENATCHEE WATER DISTRICT	894-3569
MARK NEER, P.E. (LOCAL SERVICES MANAGER)	DOUGLAS COUNTY	894-1170





ISSUED: 04/20/2014

DEMOLITION AND ROADWAY DETAILS

EAST WENATCHEE WATER POND KENTUCKY CROSSING STORMWATER POND RELOCATION

NO.	DATE	DESCRIPTION
1	04/20/2014	ISSUED FOR PERMITS
2	04/20/2014	ISSUED FOR CONSTRUCTION

POINT	ELEV.	NO. OF BINS	EXISTING
A1	963.36	14375.11	1782538.72
A2	963.45	14375.11	1782538.79
A3	963.09	14377.28	1782544.72
A4	963.14	14372.20	1782544.70
A5	963.37	14377.67	1782562.71
A6	963.84	14375.67	1782562.78
A7	944.33	14373.61	1782572.71
A8	944.40	14373.61	1782572.78

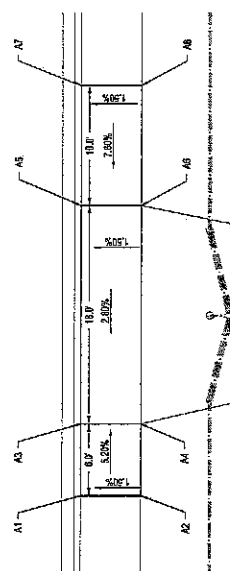

TYPICAL SECTION ROAD SECTION

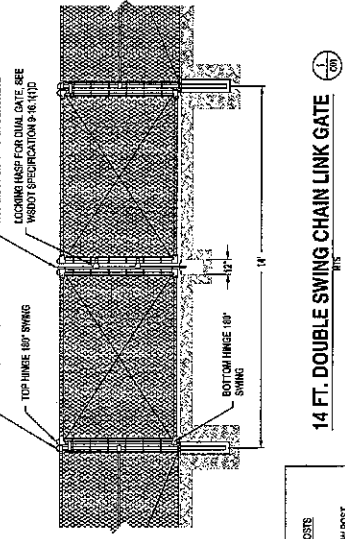
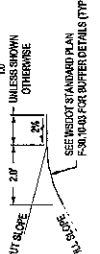
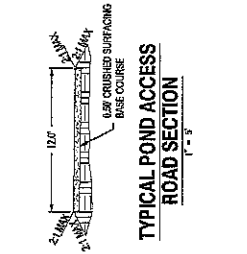
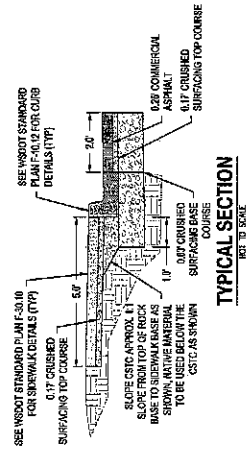

- ### DEMOLITION NOTES
- PROPOSED SURFACE FEATURES SHOWN IN GRAY ARE FOR CONTRACTOR'S CONVENIENCE IN IDENTIFYING IMPROVEMENT LIMITS.
 - WATCH DRIVEWAYS, CURBS, AND SIDEWALKS TO EXISTING JOINTS IF ONE EXISTS WITHIN 7' OF MATCH DISTANCE OR LOCATION SPECIFIED ON PLAN.
 - CONTRACTOR SHALL SMOOTH ALL LOCATIONS WHERE NEW HMA ADJUTS EXISTING PAVEMENT TO PROVIDE CLEAN EDGE. PROVIDE SMOOTH PROJECT TO FINISH AND LOCK EDGE.

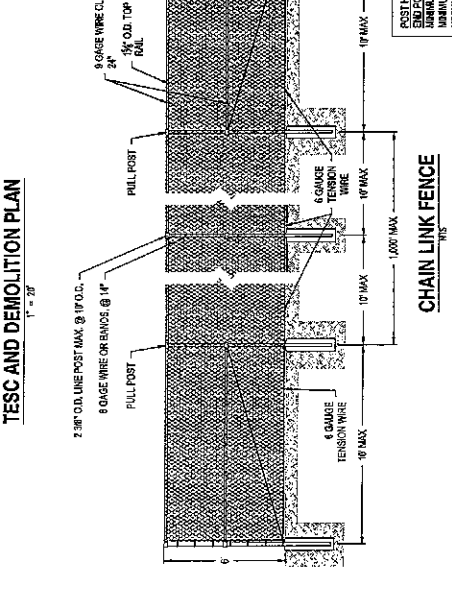
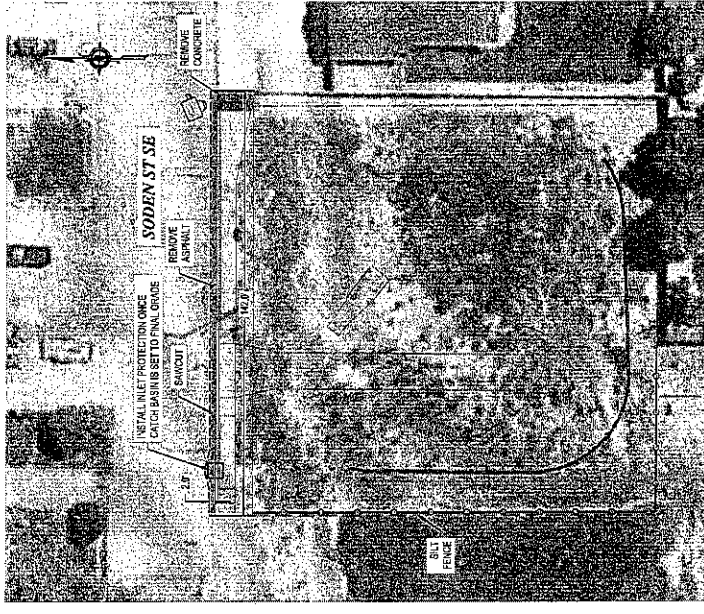



JUNE 14, 2014

EAST WEATCHEE WATER DISTRICT KENTUCKY CROSSING STORMWATER POND RELOCATION



NO.	DATE	DESCRIPTION
1	APR 22, 2014	ISSUED FOR PERMITS
2	MAY 22, 2014	REVISED PER COMMENTS
3	MAY 22, 2014	REVISED PER COMMENTS



GENERAL NOTES

1. ELEVATIONS REFERENCED IN THE PROFILES AND TABLES REPRESENT THE ASPHALT ELEVATION AT THE EDGE OF INTERSECTIONS. ELEVATIONS ARE PROJECTED THROUGH INTERSECTIONS.
2. ALL DRIVEWAY WIDTHS GIVEN IN DESIGN TABLE SHALL BE MEASURED SYMMETRICALLY ABOUT STATION GIVEN IN TABLE AND MEASURED AT FACE OF CURB.

NAME	TYPE	STATION	RINEL	PPR/SIDE
MH-1	W/CDL DOWNLID	1427.6A, 0.0	50.00	LE, RAISED, N
MH-2	W/CDL DOWNLID	1427.6A, 0.0	50.00	LE, RAISED, S
MH-3	W/CDL DOWNLID	1427.6A, 0.0	50.00	LE, RAISED, E
MH-4	W/CDL DOWNLID	1427.6A, 0.0	50.00	LE, RAISED, W
OUT-01	OUTFALL	1462.7A, 0.0	84.37	LE, RAISED, SW

NAME	TYPE	STATION	RINEL	PPR/SIDE
TYPE 1	W/CDL DOWNLID	041.0B, 0.0	52.18	LE, RAISED, SE
TYPE 2	OUTFALL	041.0B, 0.0	52.18	LE, RAISED, NW

NAME	TYPE	STATION	RINEL	PPR/SIDE
TYPE 1	W/CDL DOWNLID	041.0B, 0.0	52.18	LE, RAISED, SE
TYPE 2	OUTFALL	041.0B, 0.0	52.18	LE, RAISED, NW

VICINITY MAP

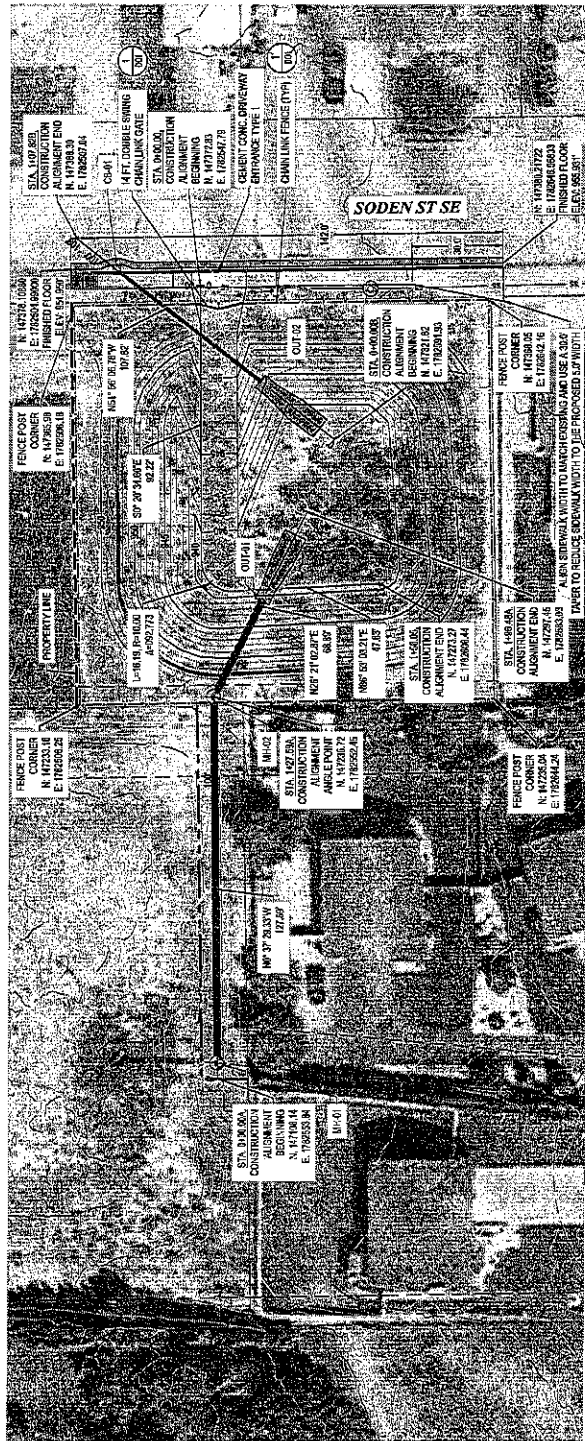
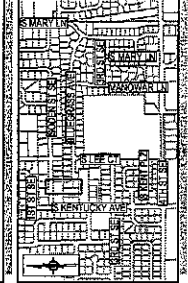

PLAN VIEW
R. 1" = 30', N. 1" = 5'

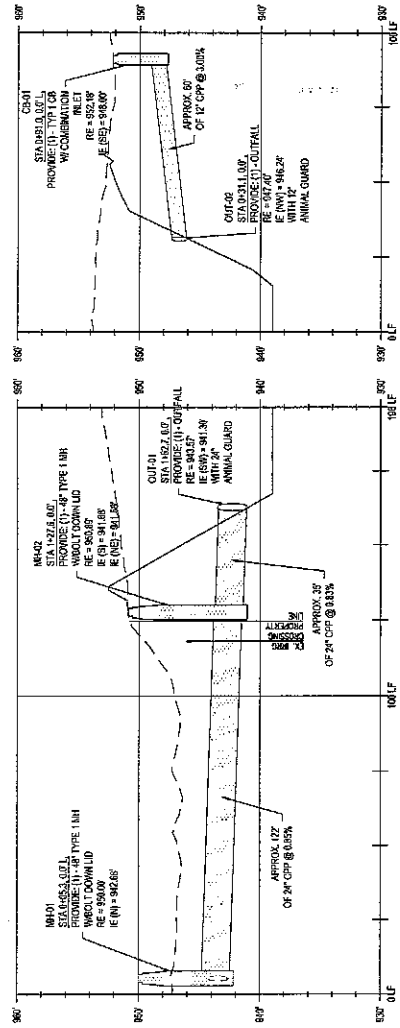

STORM RUN A PROFILE
R. 1" = 30', N. 1" = 5'

STORM RUN B PROFILE
R. 1" = 30', N. 1" = 5'